













-  Yellow Stripes = Student Parking
-  White Stripes = Employee Parking
-  Pink Stripes = Visitor Parking
-  Blue Stripes = Student Housing
-  Purple Stripes = Accessible Parking
-  Orange Stripes = Adult Basic Education Parking
-  HS Headstart Drop Off
-  Accessible Entrance
-  Welcome Center
-  Entrance Identification

ATCC Parking permits are required and valid only in their designated parking lots and in marked stalls. Parking in a lot other than the one designated on your ATCC permit, outside of a marked stall, in 15-minute/one hour stalls (beyond the allotted time), or in No Parking Zones will result in fines, immobilization, or towing.

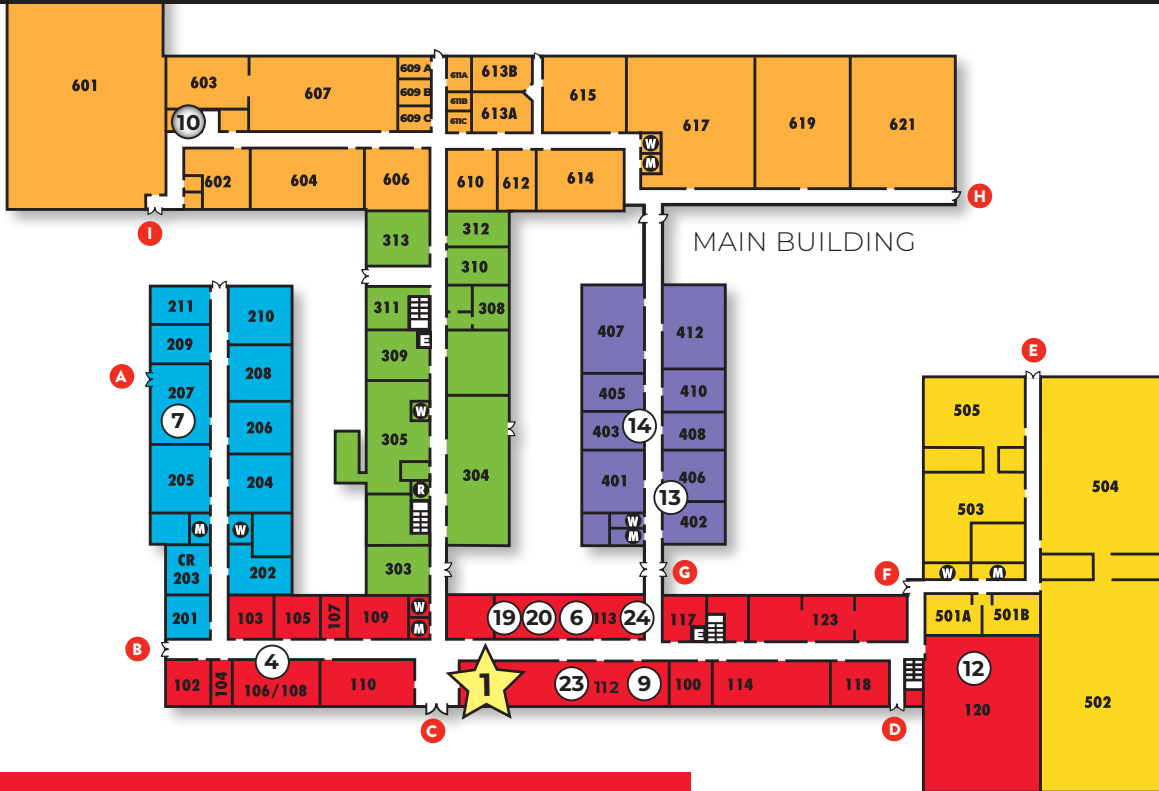

1100 BUILDING

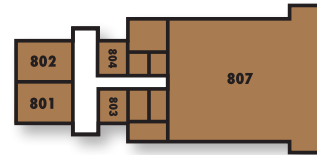

800 BUILDING



700 SOUTH BUILDING  
2<sup>ND</sup> FLOOR

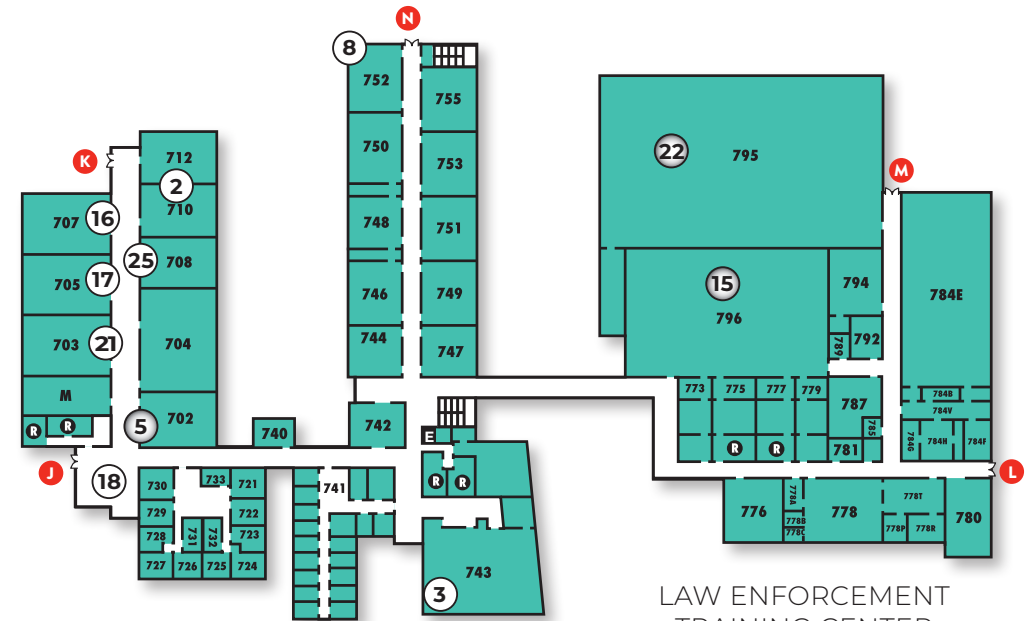

NORTH 700 BUILDING

SOUTH 700 BUILDING

LAW ENFORCEMENT TRAINING CENTER



300 WING  
2<sup>ND</sup> FLOOR



100 WING  
2<sup>ND</sup> FLOOR

## AREAS OF INTEREST:

- ★ 1 WELCOME CENTER**
- 2 ADULT BASIC EDUCATION**
- 3 AUDITORIUM 743**
- 4 BUSINESS OFFICE**
- 5 CARDIO ROOM**
- 6 COUNSELING**
- 7 CUSTOMIZED TRAINING**
- 8 E-SPORTS ROOM**
- 9 FINANCIAL AID**
- 10 FOOD PANTRY (JENNIE'S CUPBOARD)**
- 11 GALLERY 300**
- 12 GYM**
- 13 HEAD START**
- 14 IT DEPARTMENT**
- 15 LAW ENFORCEMENT GYM**
- 16 LIBRARY**
- 17 THE LINK**
- 18 LEGENDS LAPTOP LOUNGE**
- 19 PSEO**
- 20 TRANSFER/ADVISING**
- 21 STRENGTH ROOM**
- 22 TACTICAL WAREHOUSE**
- 23 TESTING**
- 24 REGISTRAR**
- 25 VETERANS CENTER**
- 26 REFLECTION ROOM**